

Viewing Window

This document is prepared to give an overview of the design, connection and maintenance requirements of the Beech Ovens Viewing Window accessory.



Overview

A popular accessory to any Beech Oven is a viewing window. This allows the public a comprehensive view inside the oven whether it be to view the chefs cooking, the food being cooked, the flames of the oven or generally to entice guests with the ambience of a wood fire.

The viewing window can be located on virtually any wall on the outer surface of any oven in the Beech Ovens range of stone hearth ovens. We recommend a minimum 200mm of oven wall between the window and any other opening in the oven wall on round ovens and 100mm on rectangular ovens as to keep the structural integrity of the oven. (See diagrams below)

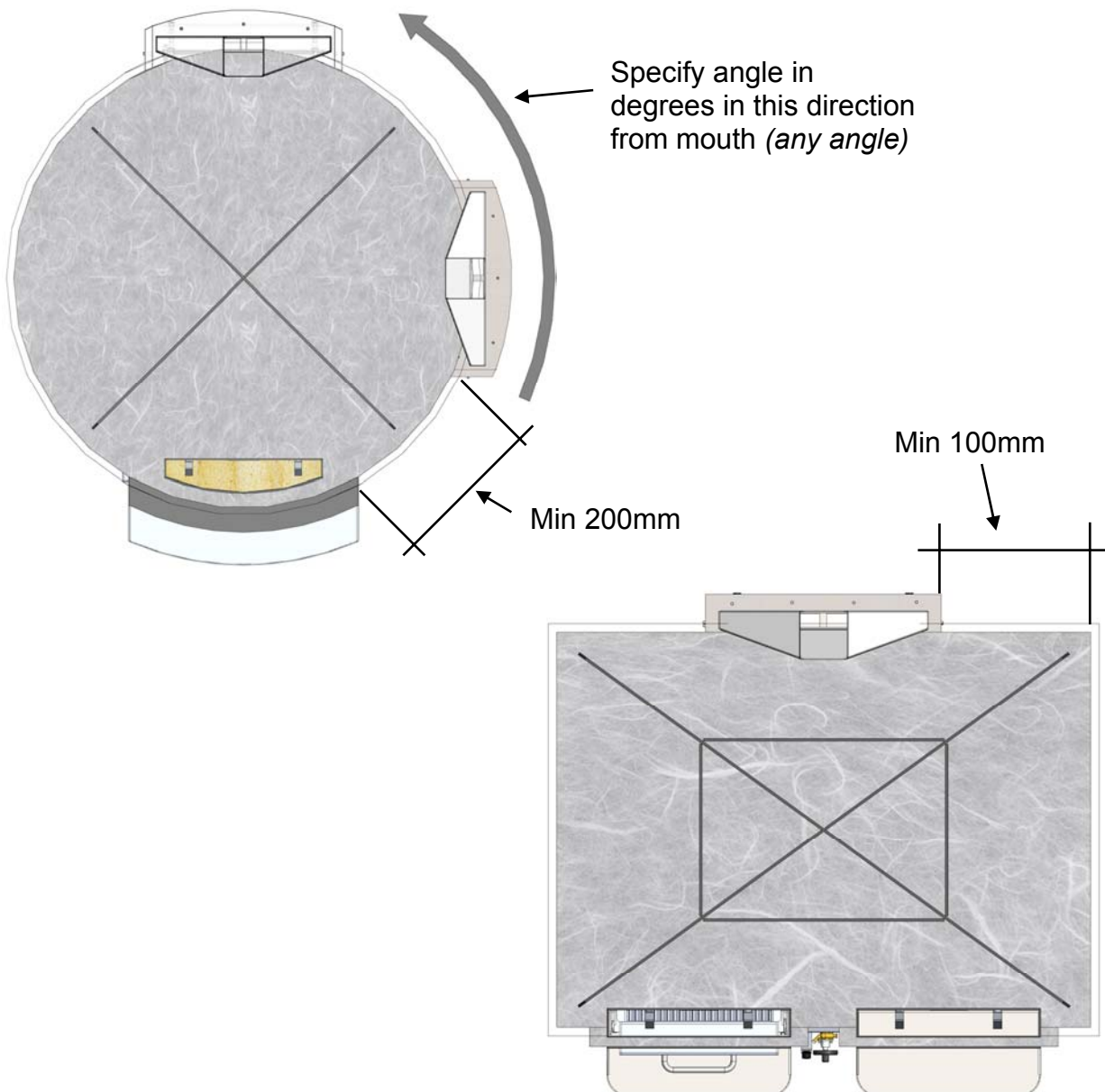

Beech Ovens Engineers have designed the window assembly to enable a safe surface temperature on the outer glass so there is no danger of hands being burnt whilst admiring the chefs at work. This is achieved using a combination of heat resistant glass, innovative new heat reflective glass and a venting system between the different layers of glass on the window.

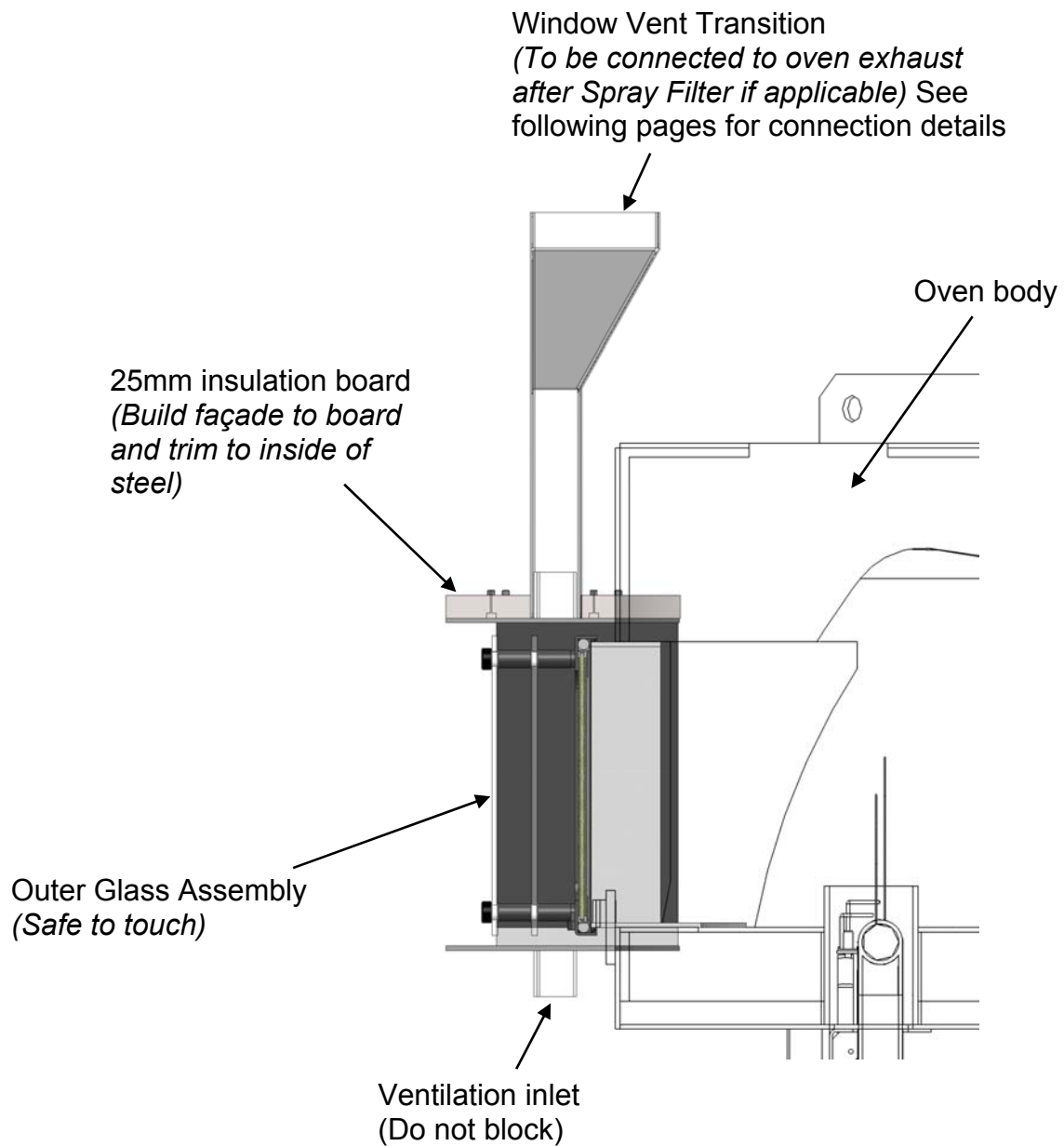

Window Installation

From July 2010, Beech Ovens have introduced a new design for the viewing window assembly. This new design is to ensure that the outer surface temperature of the viewing glass is safe to touch and the surrounding façade materials do not damage from excess heat transfer from the viewing window.

To ensure the window is not damaged in transit, it is packed separately to the oven. The diagram below illustrates how the viewing window is fitted into the oven.



NOTE: *Be careful not to damage the edge of the glass on the steel frame of the window.*

Once unpacked, the outer glass assembly needs to be removed from the window.

Remove the top 2 plastic caps ONLY.
Do **NOT** remove the bottom 2!

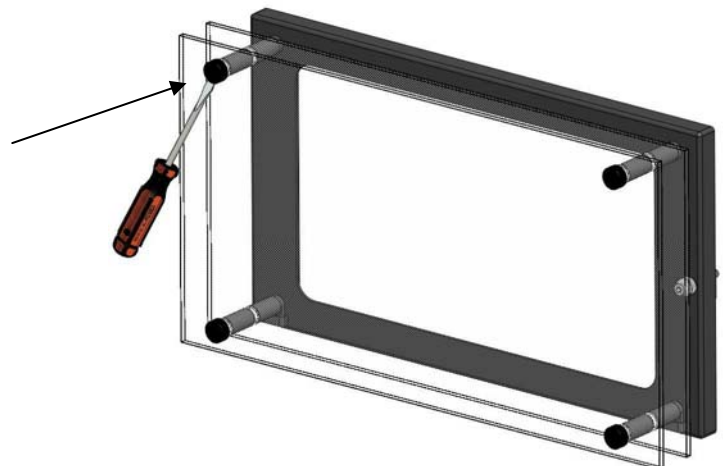

Remove the top 2 screws using a 4mm hex key.
NOTE: Hold the glass in place so it doesn't fall outwards.

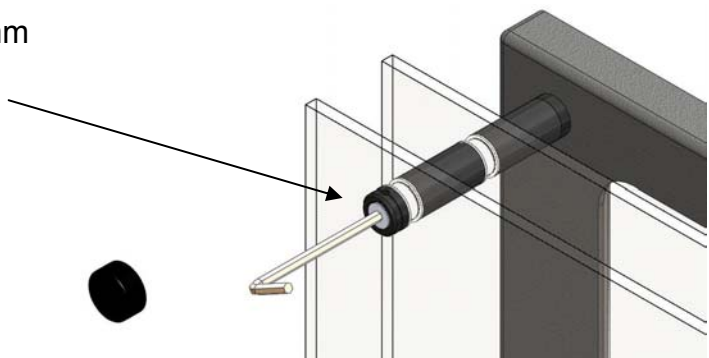

Carefully lean the top of the outer glass assembly forward (1) and lift so the lugs on the bottom release (2).

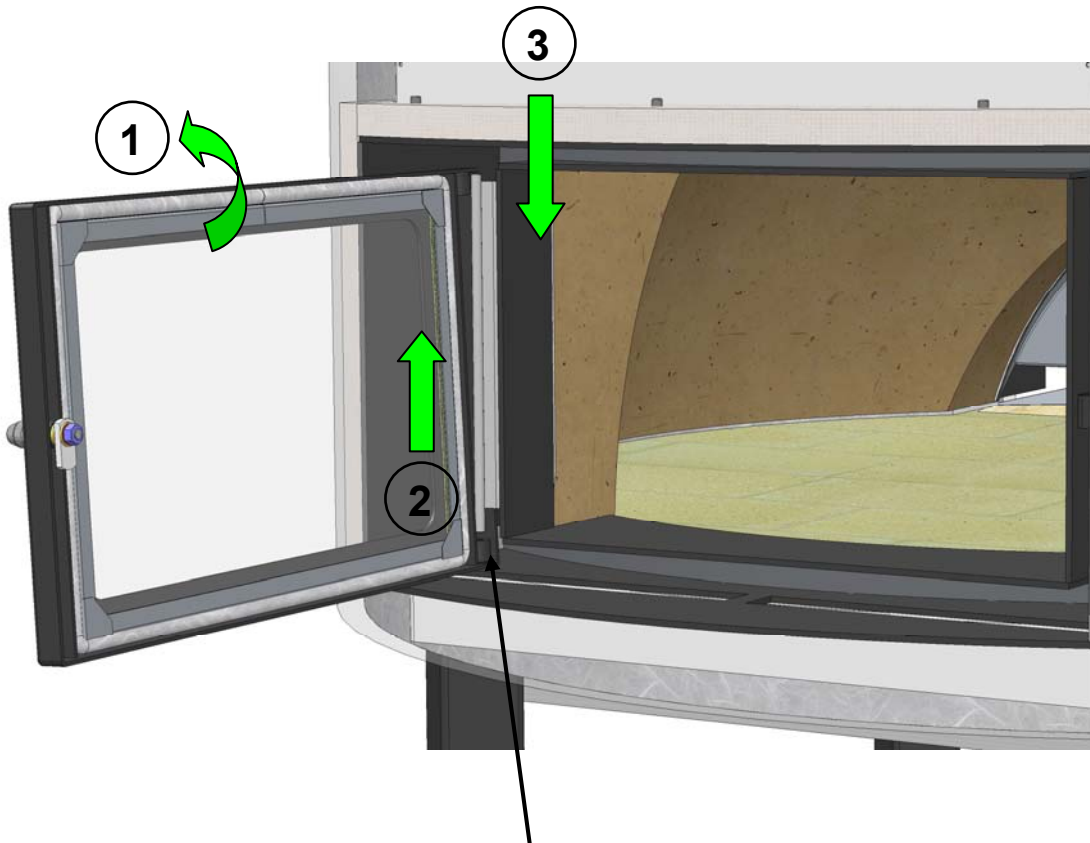
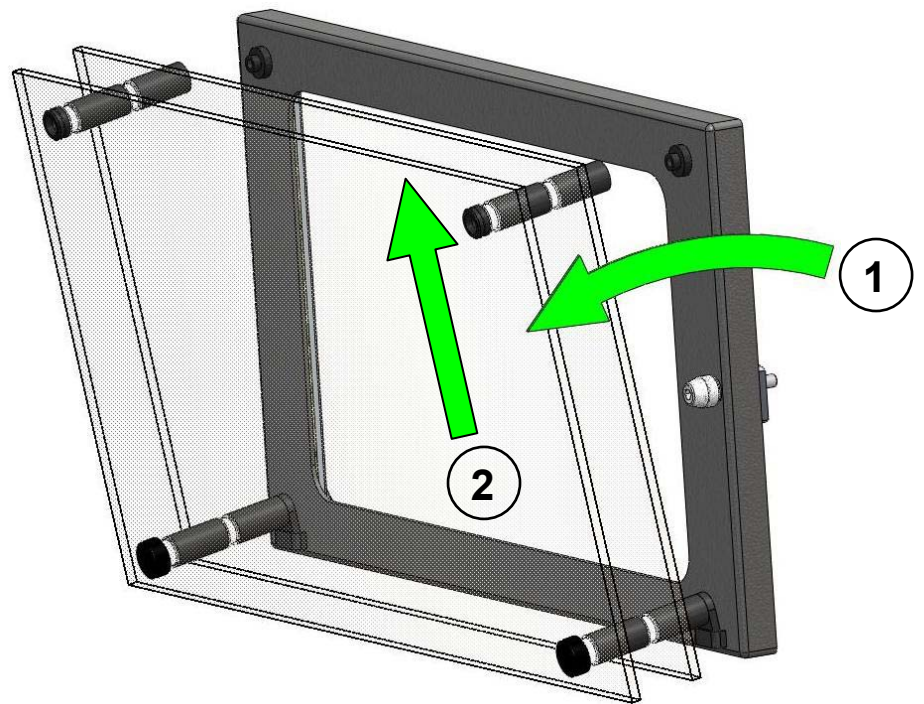

Tilt the window out slightly at the top enough to allow the bottom hinge cylinder to slip over the bottom of the hinge rod.
Lift and tilt back and let the top hinge cylinder slip over the top of the hinge rod.

Close the door and lock with a 6mm hex key.

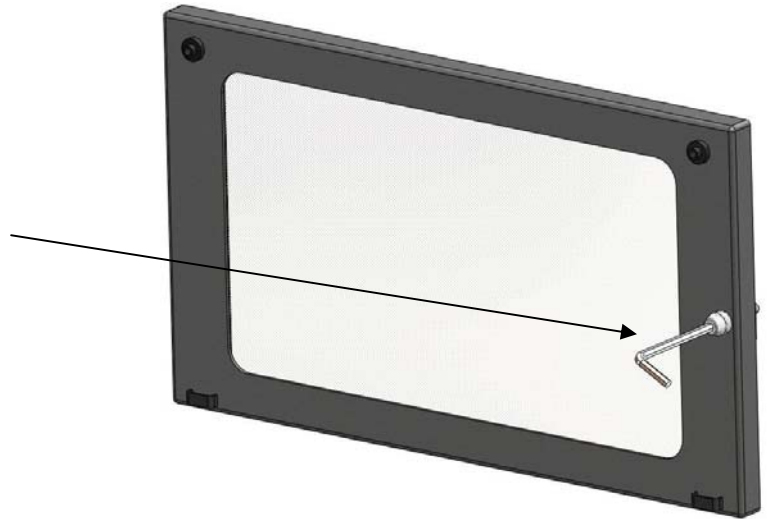

Remove the hex key and re-fit the outer glass assembly in reverse order.



NOTE: *Ensure that the plastic caps are fitted as the steel section will become very hot during use.*

Most windows will need to be trimmed to the façade wall. Ensure that the trims do not cover the vent slots in the top and bottom of the window frame. The slots are to allow cool air to circulate past the glass to keep it cool.



Window Vent Connection

All viewing windows are now delivered with a window vent transition, 2 x duct spigots and flexible duct which should be connected to the exhaust duct. For those installations using a Spray Filter, this connection should be made at least 200mm after the Spray Filter.

The diagram below outlines the window vent correctly connected.

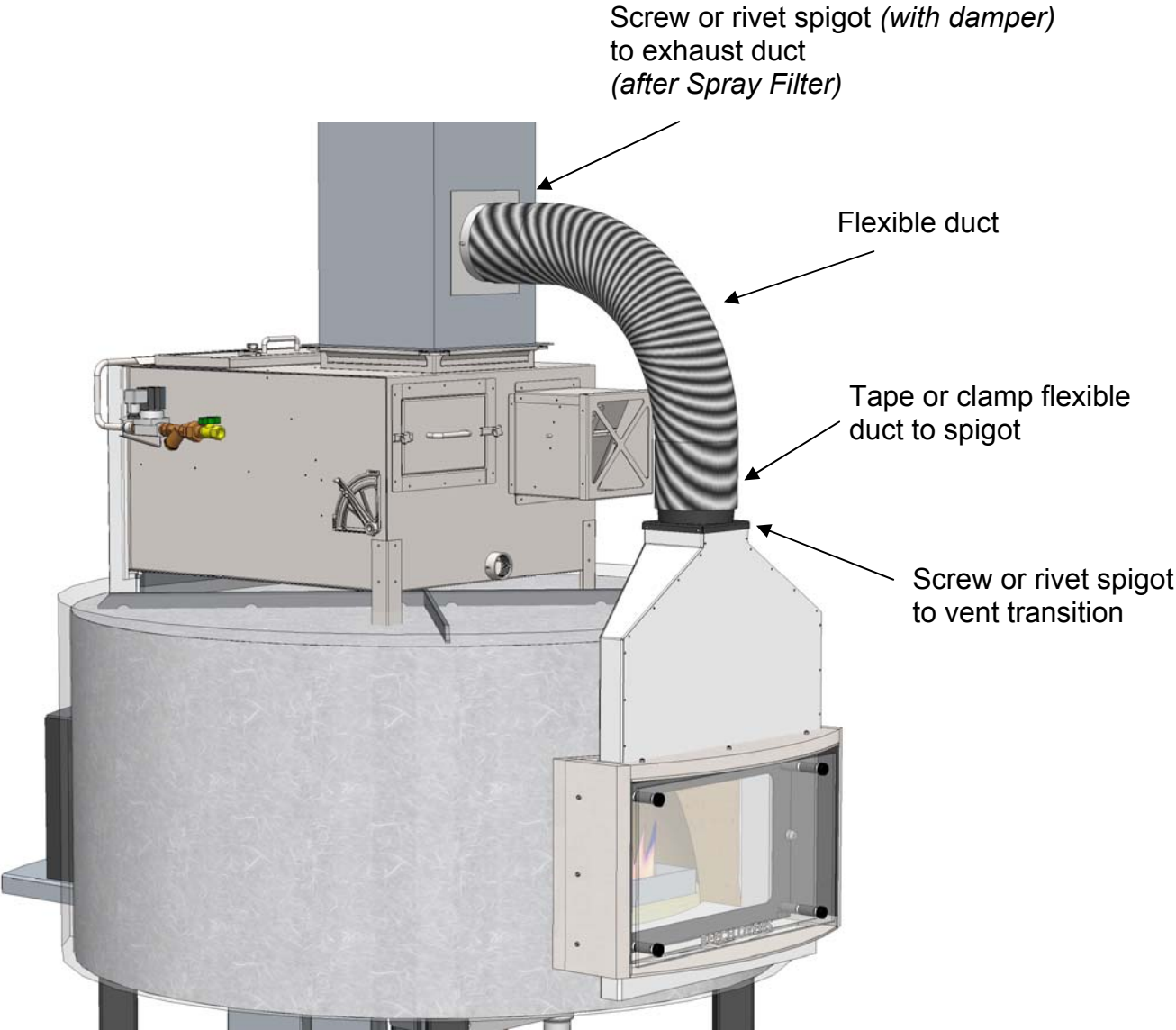

Window Maintenance

Some ovens have a viewing window accessory which enables the internal of the oven to be viewed by the public to enhance the visual experience of stone hearth cooking. In some cases the window may need to be cleaned as soot and smoke can contaminate the inner glass.



Note: *Only open the oven viewing window when the oven is OFF and cool.*

There are a number of different cleaning agents available on the market, though the method below explains a simple, cheap and effective method to cleaning the inner glass.

Cleaning the Internal Glass

Using a sheet of regular newspaper, scrunch the sheet and lightly dampen the paper in water. Apply the damp newspaper to some of the cool ash from the wood fire and lightly wipe the glass to loosen the soot from the glass. When the soot is dissolved, use a fresh sheet of damp newspaper to clean the remainder of the soot from the glass.

This method also helps to prevent the build up of soot on the glass.

NOTE: Do not use any acidic or harsh cleaning agents to clean the glass, as they could damage the protective coating on the glass.

The following page shows the sequence to remove the outer panes of glass to gain access to the handle to open the viewing window.

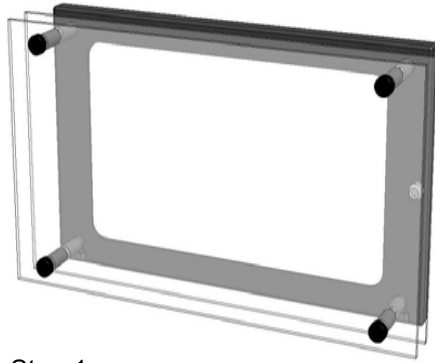

Step 1

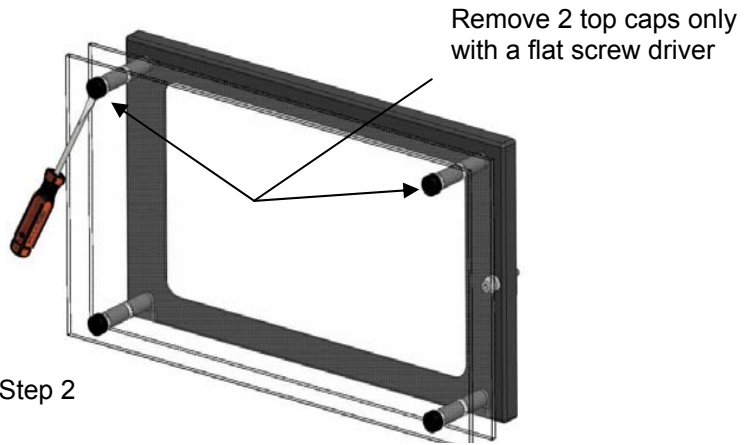

Step 2

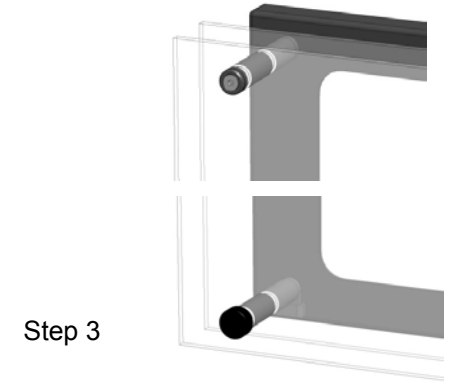

Step 3

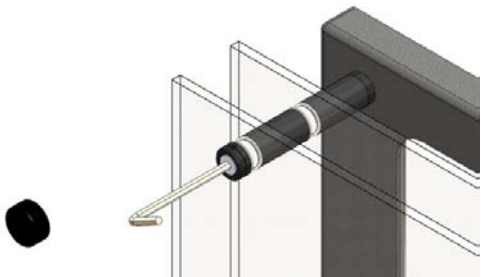

Step 4

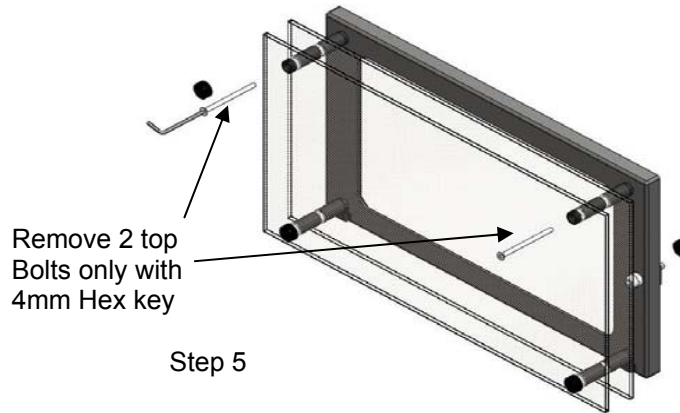

Step 5

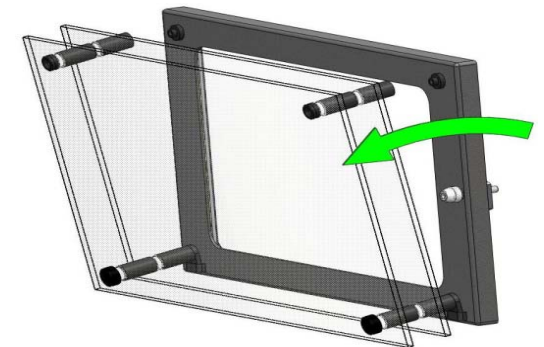

Step 6

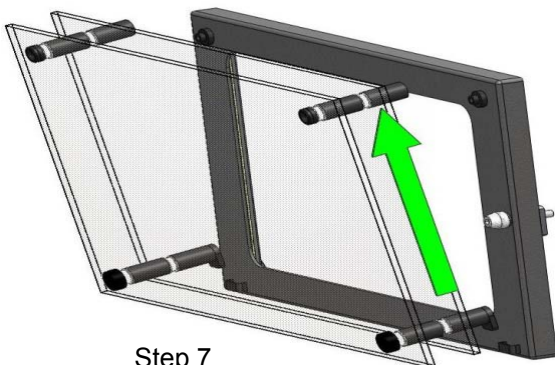

Step 7

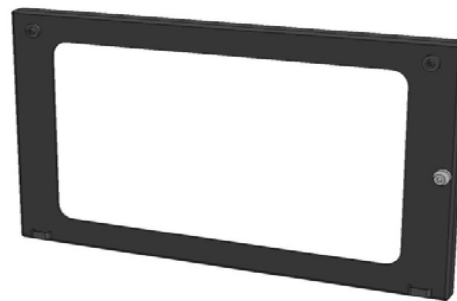

Step 8

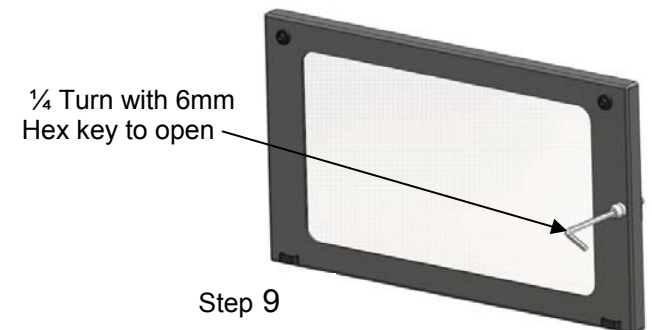

Step 9